

BRAUSSE | 1050SEF

Automatic Foil Stamping Machine with Diecutting & Stripping Capabilities



Outstanding Features

- Turbo air blast at feeder head for easy separation of thinner paper.
- Tonnage gauge system, which can be set at a pre-determined parameter, up to a maximum of 300 tons.
- Automatic impression on/off with tonnage searching program to re-set the tonnage to the previously set figure after machine stoppage.
- 12-zone heating unit built in upper platen with individual temperature controls.
- Computer controlled foil pulling unit with standard 2-pull. Optional 3rd pull can be added.
- Dynamic servo motors to accommodate better accuracy at high foil stamping speeds.
- Computerized programmable foil puller to accommodate a variation of short and long pulls.
- Foil unwinding with automatic machine speed tracking for smooth foil advancing.
- Fully computer controlled air blast system to assist in foil separation, but it can also be programmed to smooth out thinner stock before stamping.
- Easy-to-lock foil holding bracket for extremely quick changeover, which will support an 8" diameter foil roll (4000-5000 ft, depending on the type of roll).
- Foil splitter to split the wide webs of foil to narrow webs, to fit through window at delivery; and then into rewinder.
- Outside free-standing foil rewinder unit which consists of 6 rewind shafts driven by high torque variable speed motors.
- Very unique series of dancing rollers in rewind unit to assist in taking up foil slack, even on narrow foil webs, thus allowing machine to stamp at speeds never achieved before.
- Machine also comes equipped with full stripping capability, including gripper edge waste removal and very easy to change from foil stamping to diecutting and full stripping.



Foil Puller Control Console



Cross Pull Unit (Optional)



Servo Motor for Foil Puller



Foil Rewinder System

Technical Specification

Max. sheet size	1050 x 750 mm (41 1/8" x 29 1/2")
Min. sheet size	400 x 370 mm (15 3/4" x 14 1/2")
Max. cutting size	1041 x 730 mm (41" x 28 3/4")
Min. gripper margin	9 mm (23/64")
Inner chase size	1145 x 755 mm (45" x 29 3/4")
Size of cutting plate	1080 x 736 mm (42 1/2" x 29 3/8")
Stock range	.01 - 2 mm (0.0039" - 0.078")
Max. pressure	300 tons
Max. mechanical speed	7,500 cycles/hour
Main motor	11 kw (29 Amp)
Other power required	9 kw (24 Amp)
Heater for 1050SEF	24 kw (63 Amp)
Overall length	7018 mm (23')
Overall width	4189 mm (13' 9")
Overall height	1967 mm (6' 5 1/2")
Total weight	15.5 tons

Hot Foil Stamping & Embossing Unit

Individually programmable 2-draw foil puller(3-draw optional).
12-zone Heating Base complete with honeycomb diechase and temperature controls.

Max. width foil	1020 mm (41")
Max. stamping width	1020 mm (41")
Max. stamping depth	730 mm (28")
Max. foil pull	730 mm (28")
Foil supply bars max capacity	200 mm roll diameter (8" roll diameter)
Rewind unit max. capacity	400 mm roll diameter (16" roll diameter)
Temperature control range	0-200°C (392°F)

In the interest of product improvement, the manufacturer reserves the right to change specifications and features without notice.

1050SEF Diecutting Machine Floor Plan

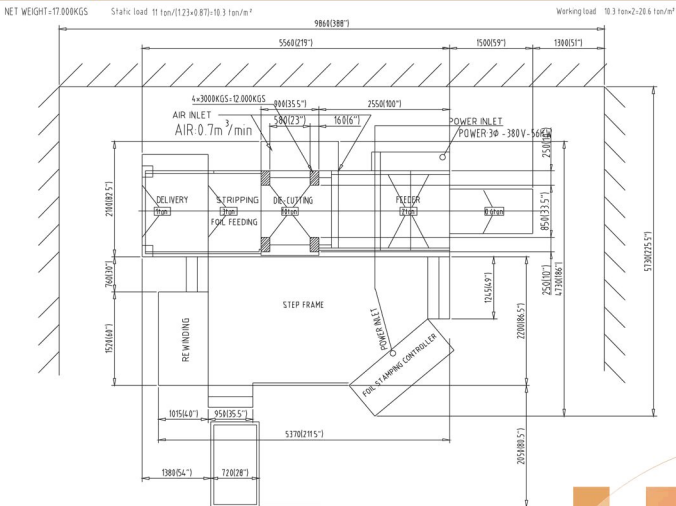

BRAUSSE GROUP

Headquarter

#1 - 1500 Valmont Way
Richmond, British Columbia
Canada, V6V 1Y4
1-888-853-4760

Tel: (604)278-2027

Fax: (604)278-1005

Email: printech@can.rogers.com

Brausse Group USA

1-888-272-8773

WWW.BRAUSSE.COM

BRAUSSE



Brausse Group's State of the Art Manufacturing Facility in Shanghai, China.

The Brausse Group

Brausse Group is the world's leading equipment manufacturer for the converting industry, with manufacturing bases worldwide. We have been supplying converting equipment to many different industries for over 25 years. The globalization of our manufacturing process enables us to maintain the highest level of product quality and innovation, at the best economical value.

Many of our facilities are either ISO9001:2000, CE and/or CSA certified for their first class workmanship. We have teams of highly trained service professionals ready to serve you because we believe that service is "the name of the game" in your daily operation.